

EMV Machine Mounting Guide

Alliance Metercase Mount Models

Coin Conversion

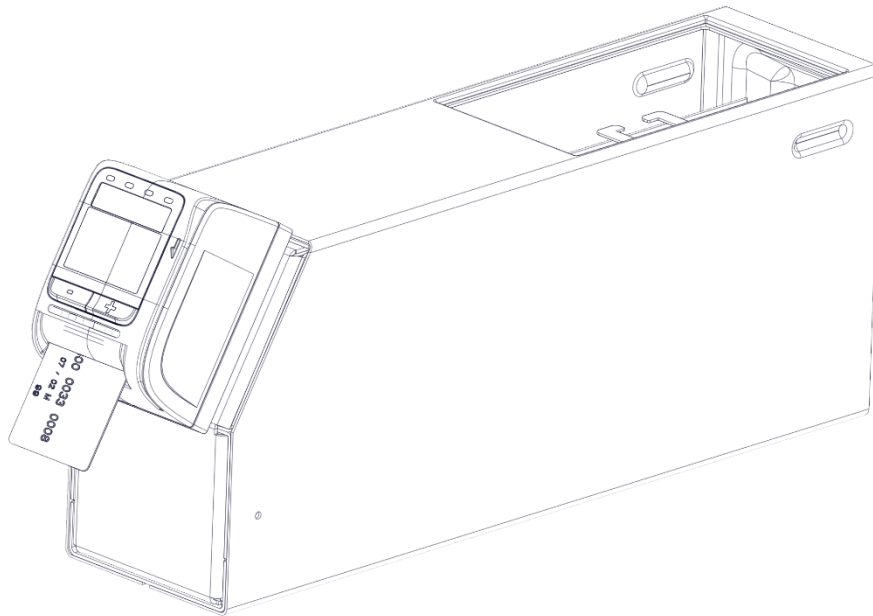

STOP



Please make sure the machine is unplugged before you start.



Tools Needed:

- Phillips Screwdriver



EMV Reader

EMV Reader

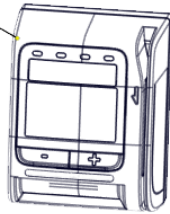

EMV Reader Screw

4x



EMV Reader Washer

4x

KIT-068039 Standard Metercase

KIT-068040 High Capacity Metercase

EMV Machine Mounting Bracket

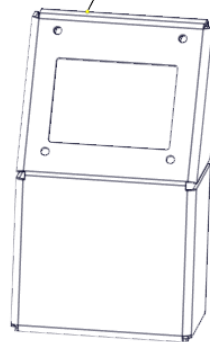

Machine Mount Wingnut



Machine Mount Washer (Large)



Bracket part number and information is located in the back interior of part.

Please be sure that it matches:

- P/N: MFP-068027 for Standard Metercases.
- P/N: MFP-068029 for High Capacity Metercases.

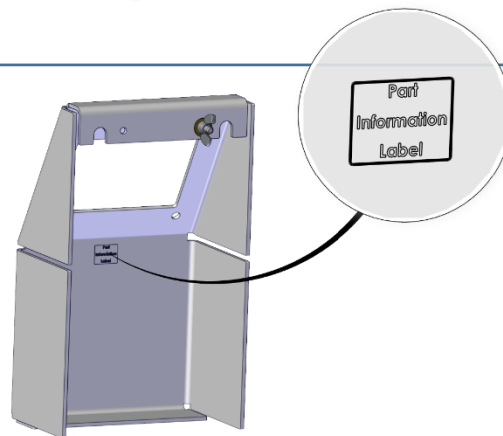

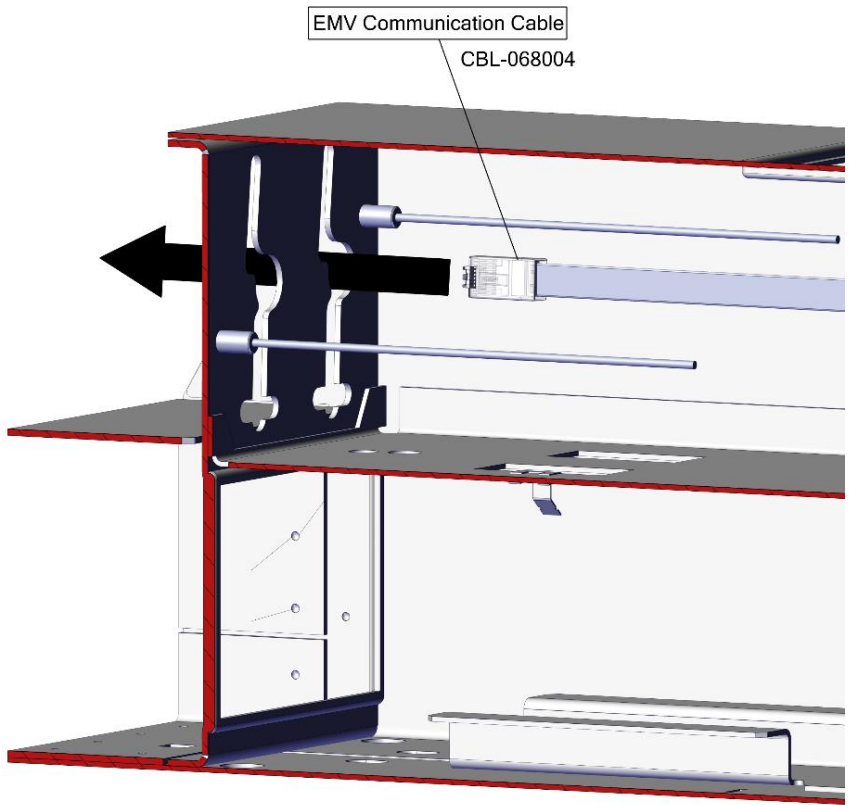

1 Insert cable through coin drop opening from inside machine so that the connector is on the outside. It does not matter which end is used as they are the same.

2 Remove hardware from the back of the reader.

The hardware should come with the reader. May not be exactly as shown due to upgrades.

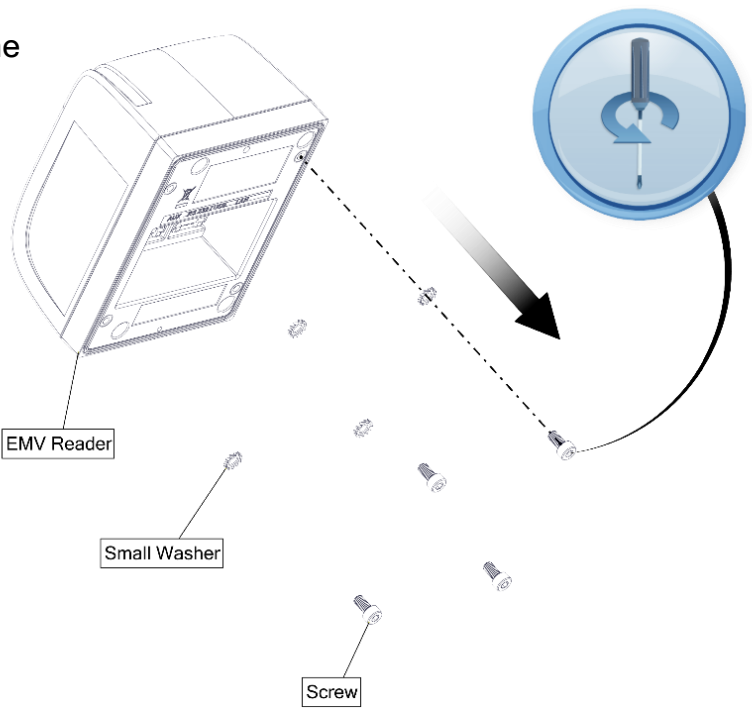

3 Attach EMV Reader to bracket using the hardware provided for the reader.

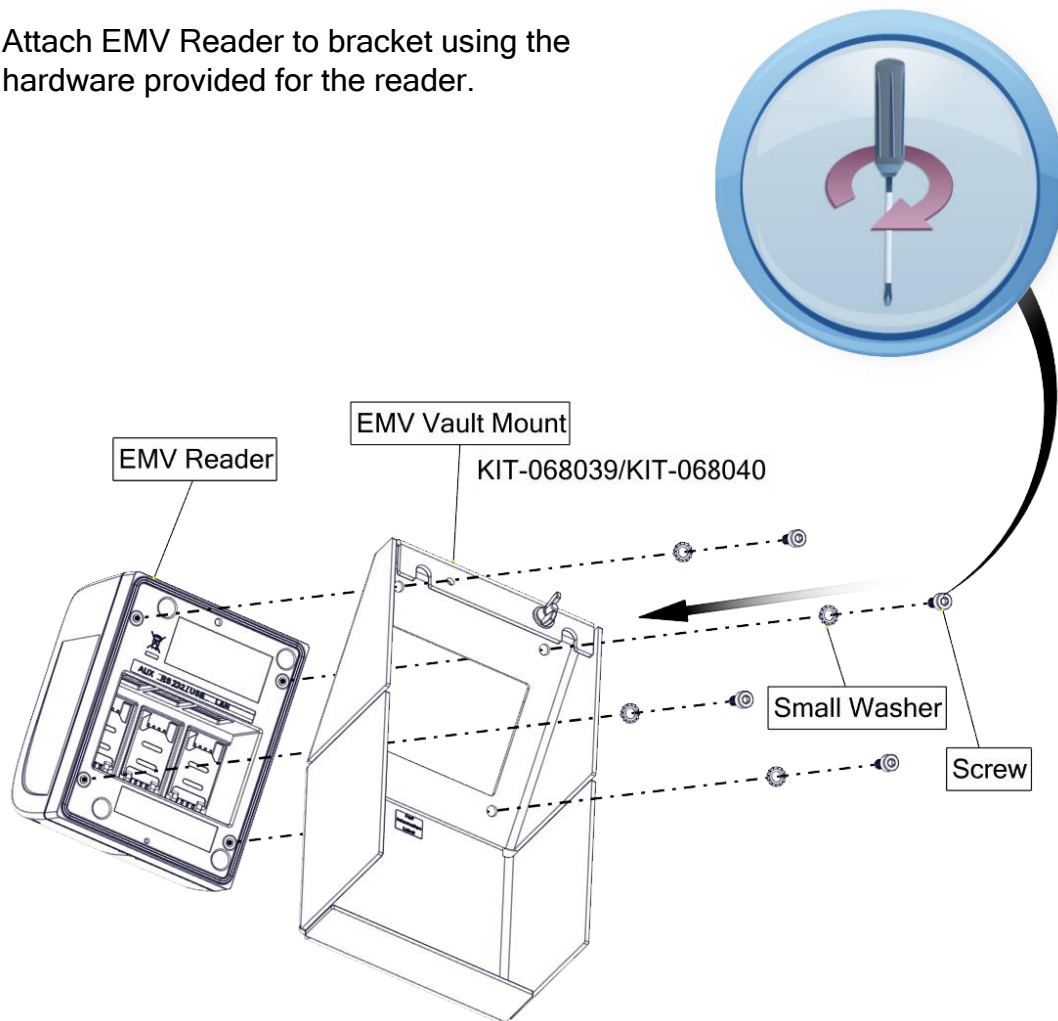

4 Insert cable end connector from outside of machine into RS 232/USB slot on EMV Reader while attached to bracket as shown.

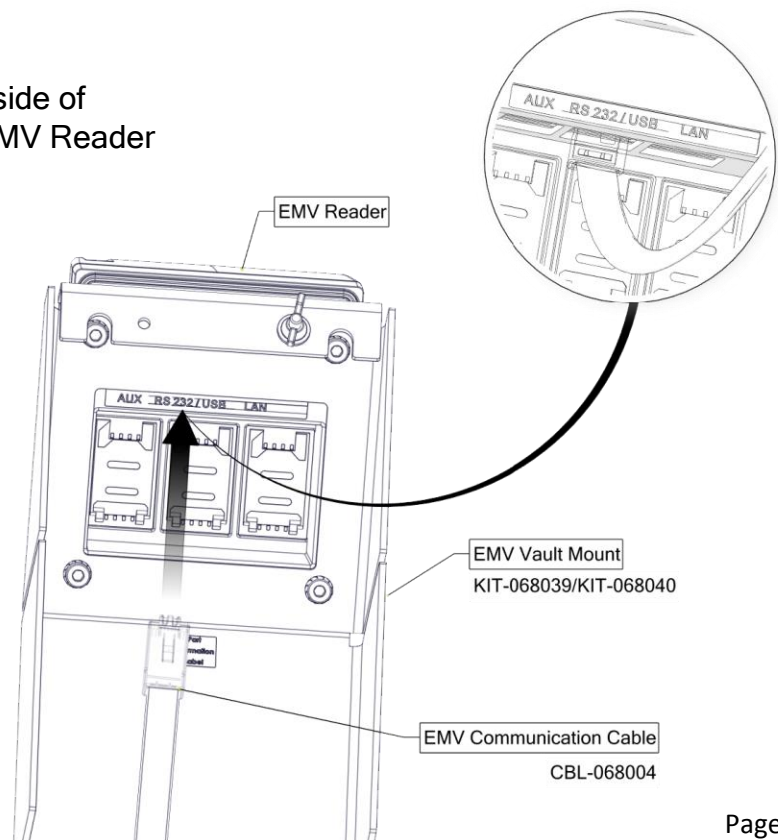

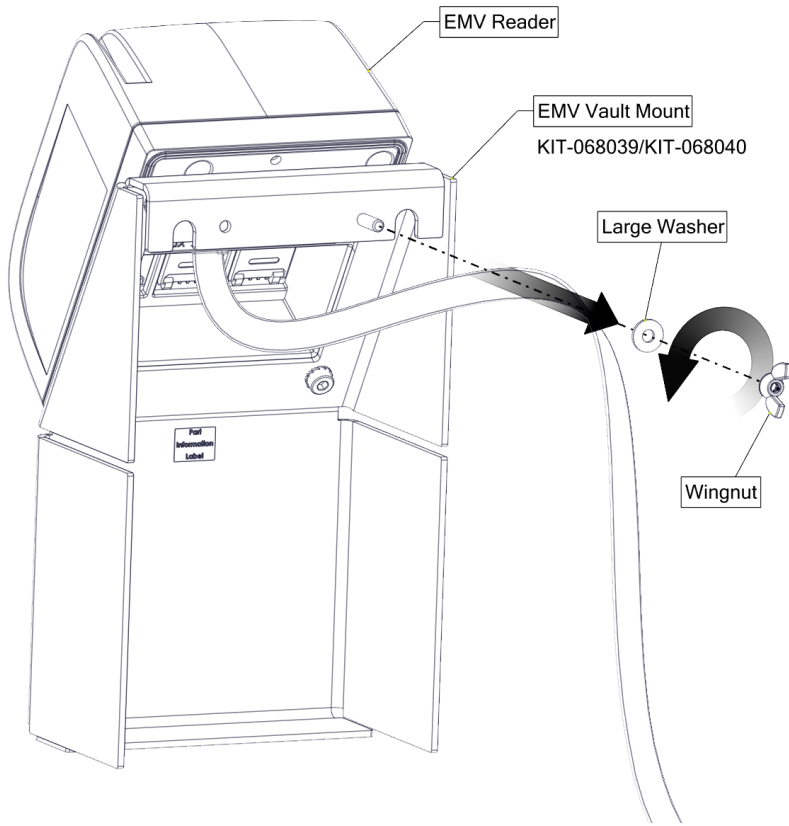

5 Remove wingnut and larger washer provided on bracket. This will be used in the next assembly.

6 Assemble EMV Reader bracket to vault by allowing the threaded stud to pass through the coin drop opening. Secure from the back with larger washer and wingnut.

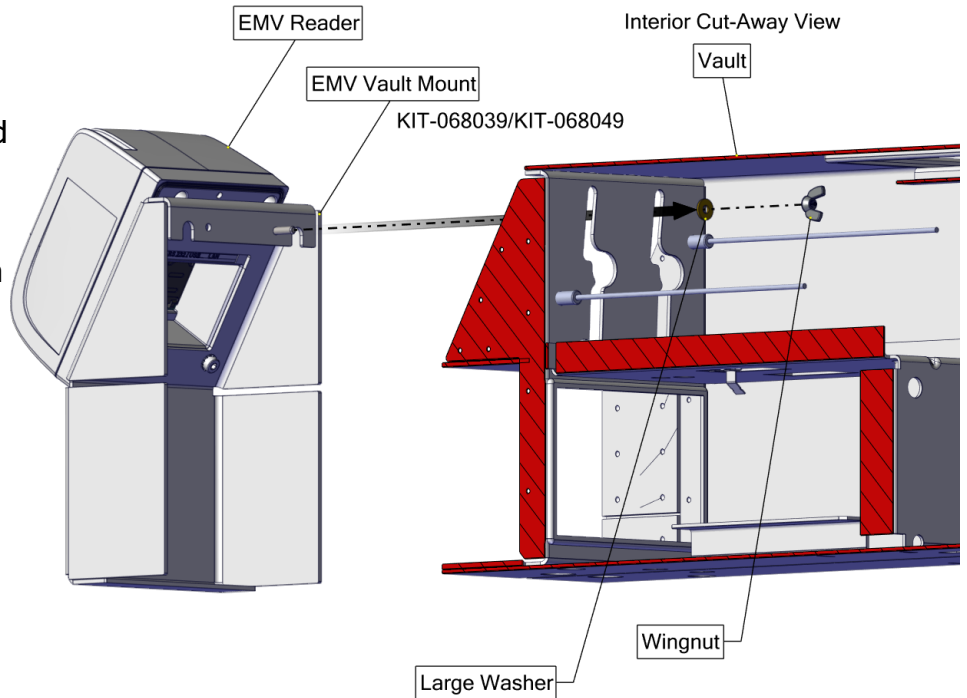

7

Finished assembly should appear similar to the image shown below.

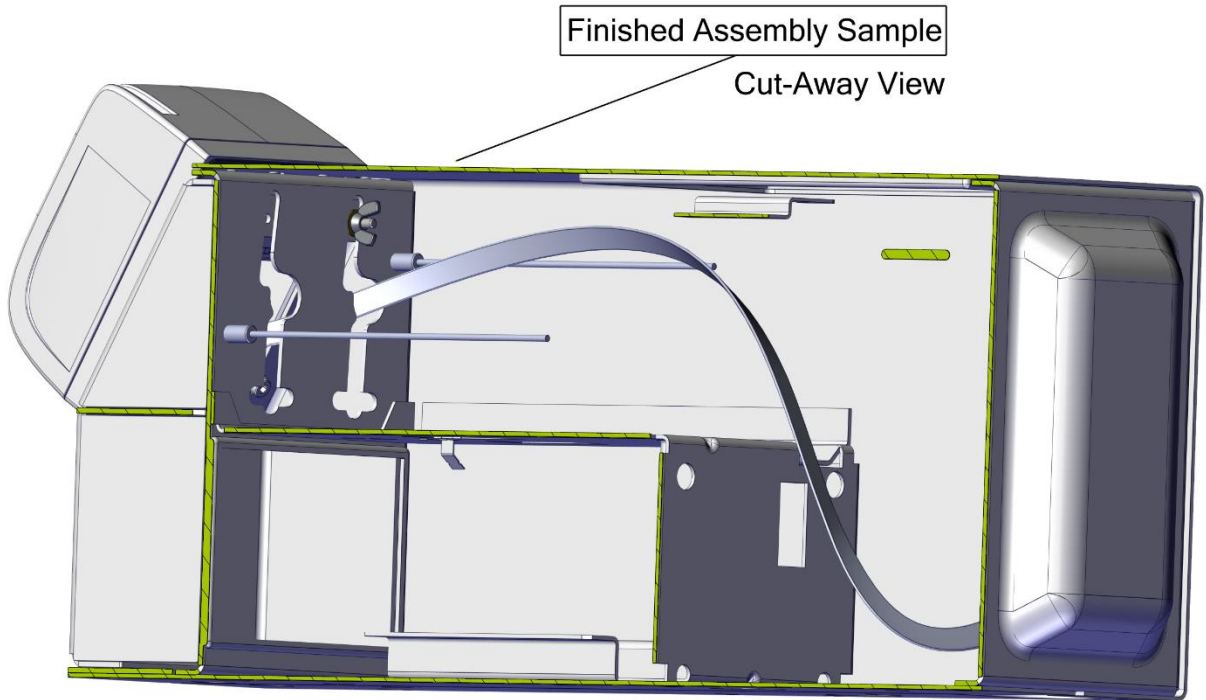



2115 Chapman Road, Suite 159
Chattanooga, TN 37421
Tel: 800-332-4835
Fax: 423-855-7554

For Sales inquiries: MicroPayments@e-hps.com

To Submit Purchase Orders: HMPOrders@e-hps.com

For Support Requests: HMPSupport@e-hps.com